

*Protecting An Investment  
Showcasing Your Collection*

**GunSafe™**

---

# Installation Instruction Manual

---

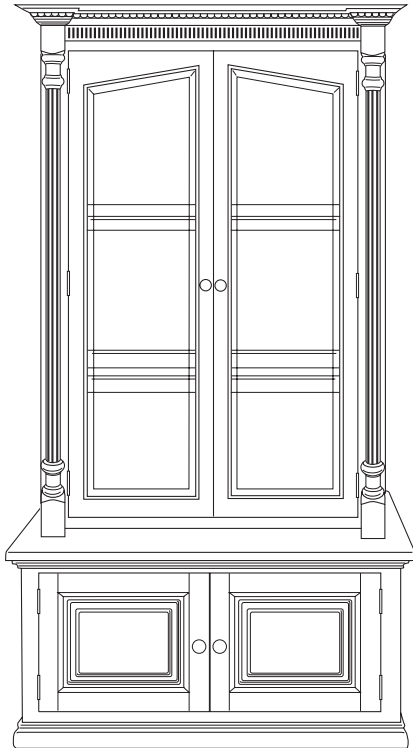

GunSafe Cabinet  
(pages 1-8)

Seller assumes no obligation for failure of an architect, installer or home owner to comply with all applicable law ordinances, building codes and safety requirements.

GunSafe Pistol Display  
with Optional Base  
(pages 14-18)

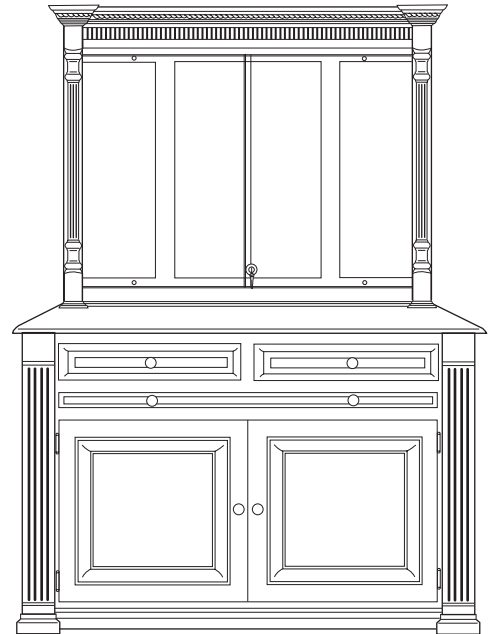

GunSafe  
Deluxe Cabinet  
(pages 9-13)

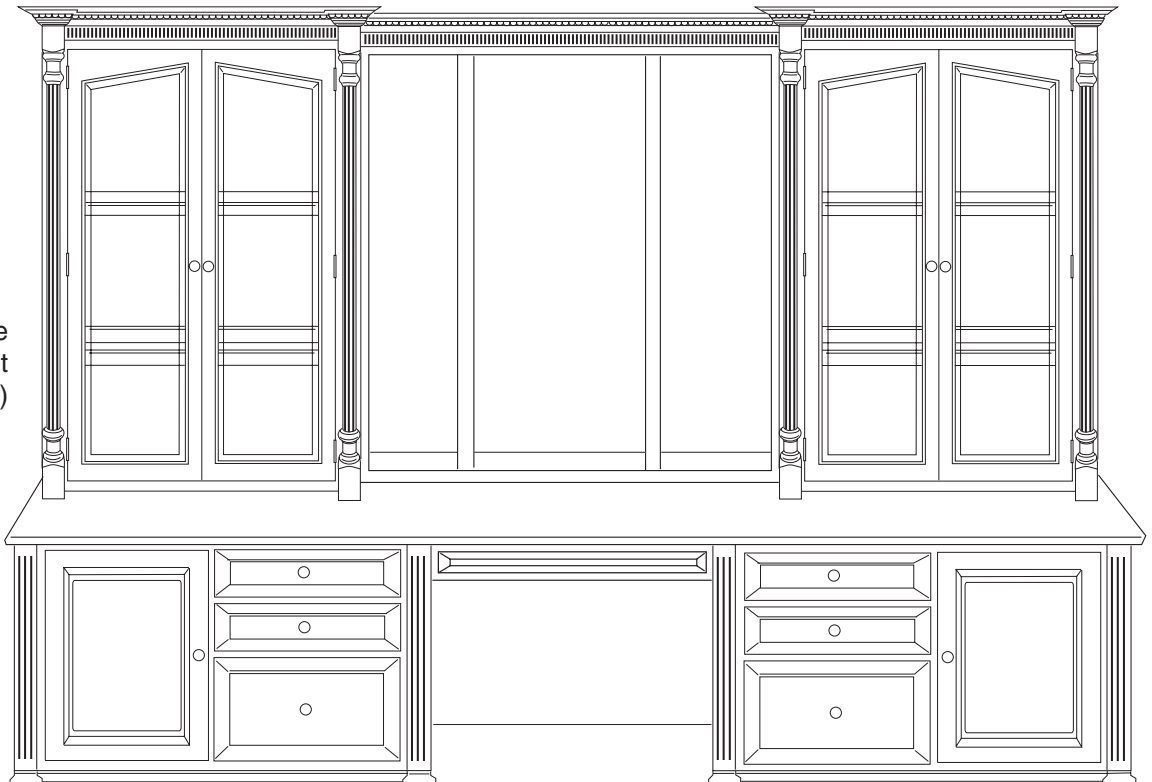

To our Valued Customer:

Thank you for purchasing GunSafe. We are honored to have hand-created the hardwood cabinet of your choice and are certain it will provide a lifetime of enjoyment.

Your cabinet has been carefully secured for safe delivery to you. Installation is simple and straightforward if you follow these instructions. Please call us toll-free at 1-877-448-6723 if you have any concerns or need additional information.

In only a short while, your cabinet will be ready to protect your firearms or other sporting collectibles. Soon, you can showcase your collection to family and friends.

We wish you all the best and once again appreciate your trust in GunSafe.

Sincerely,

William Schlabach  
GunSafe founder

## Tools Needed

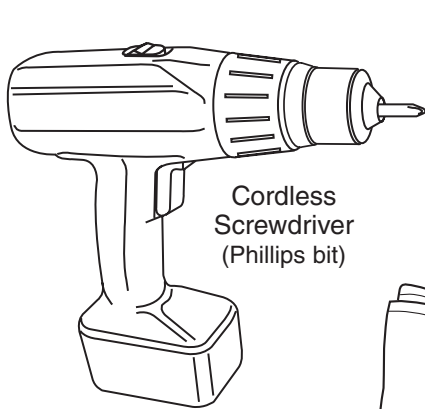

Cordless Screwdriver  
(Phillips bit)

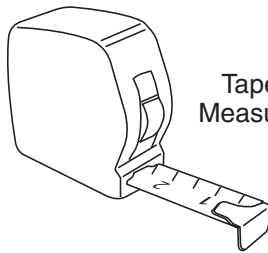

Tape Measure

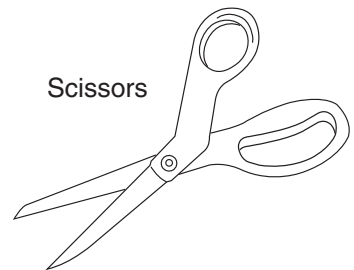

Scissors

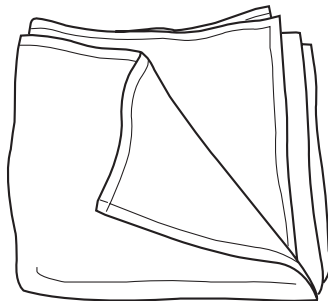

Furniture Pad

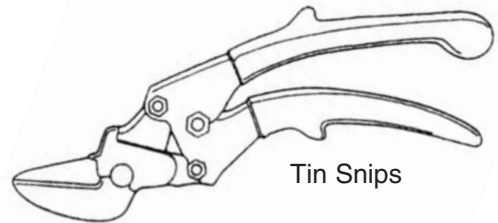

Tin Snips

## Hardware (provided)

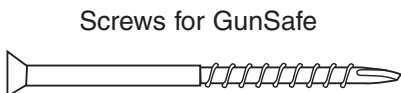

Screws for GunSafe

6 – #8 x 1<sup>3</sup>/<sub>4</sub>"

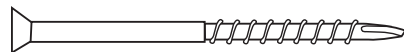

Screws for GunSafe Deluxe

26 – #8 x 1<sup>1</sup>/<sub>2</sub>"

24 – #8 x 1<sup>1</sup>/<sub>4</sub>"

## Step 1

Your GunSafe cabinet will arrive on a pallet containing two shrink-wrapped boxes.

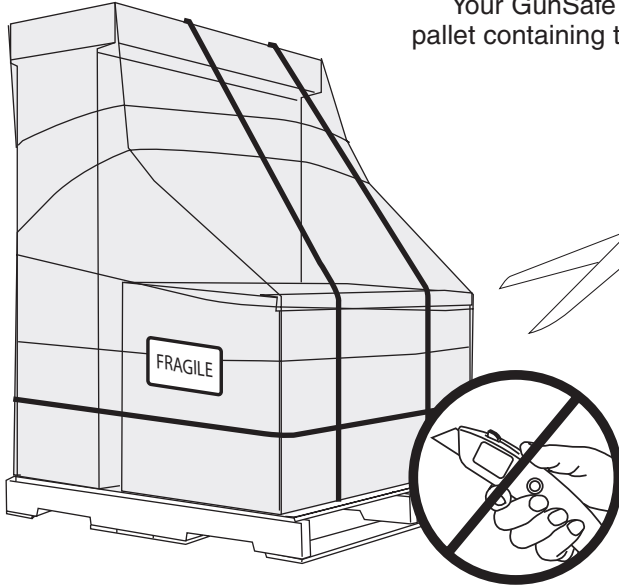

Use a scissors to remove shrink wrap, plastic and tape.

Do Not use knife.

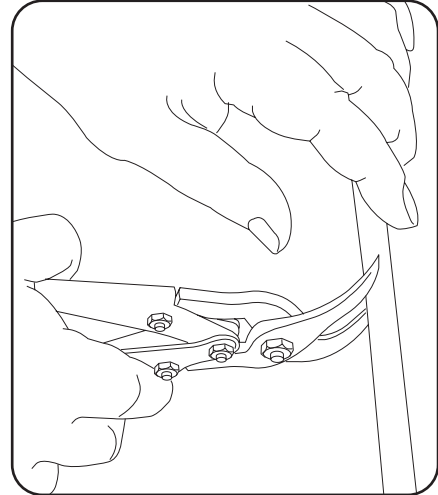

Use a tin snips to cut plastic bands.

### NOTE

It is necessary for 2 or more people to set up your GunSafe.

## Step 2

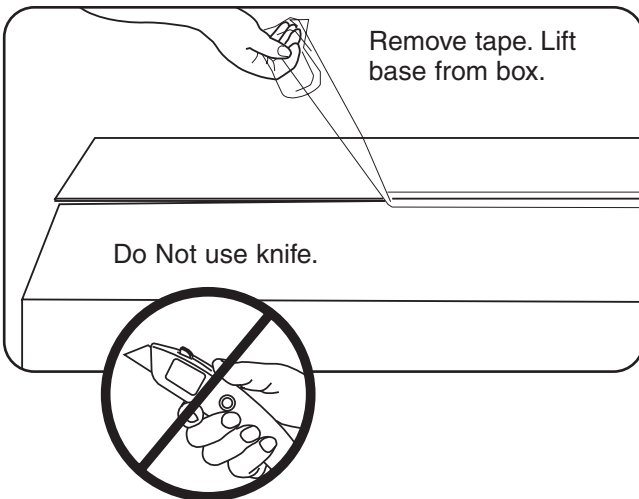

Remove tape. Lift base from box.

Do Not use knife.

### NOTE

Carefully unpack your GunSafe cabinet. Remove all packing materials.

## Step 3

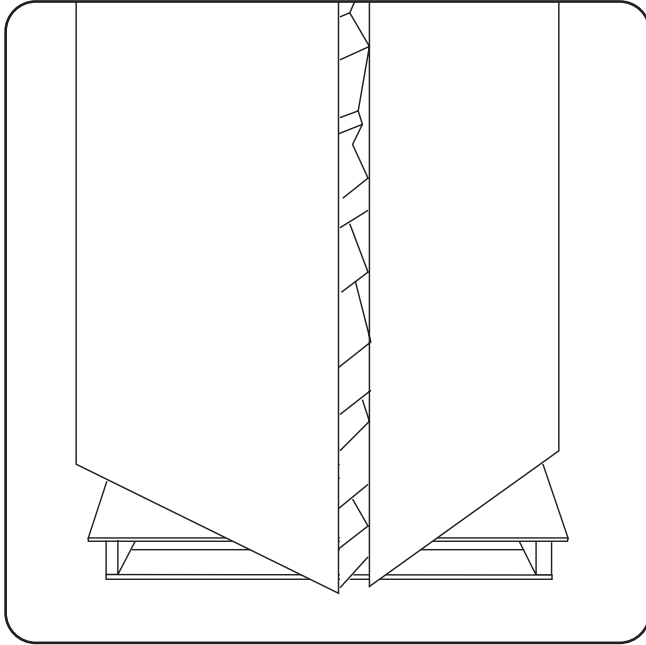

Remove all packing materials from cabinet.

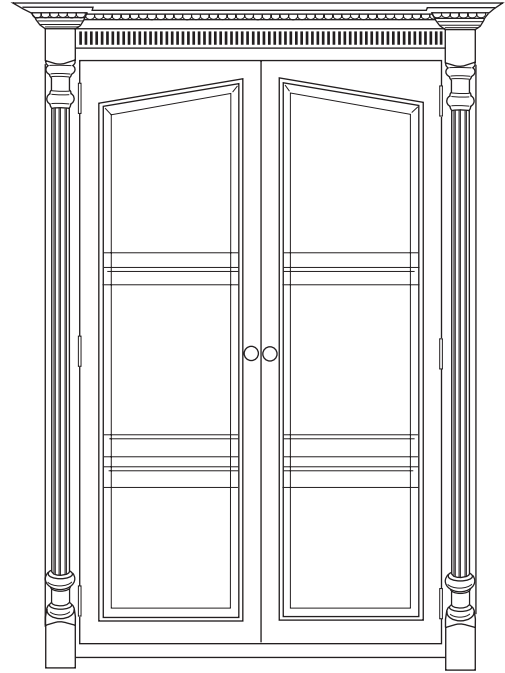

## Step 4

Place GunSafe base section approximately 6" forward from wall where GunSafe display will be placed.

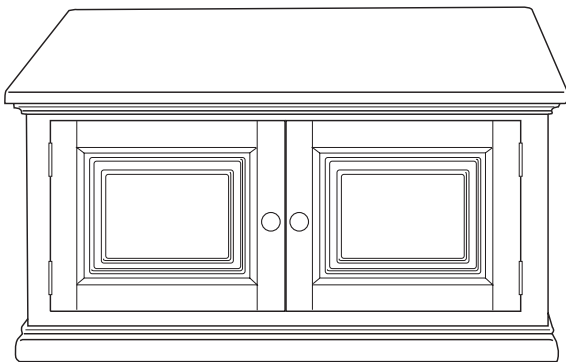

### NOTE

Place near electrical outlet for light kit.

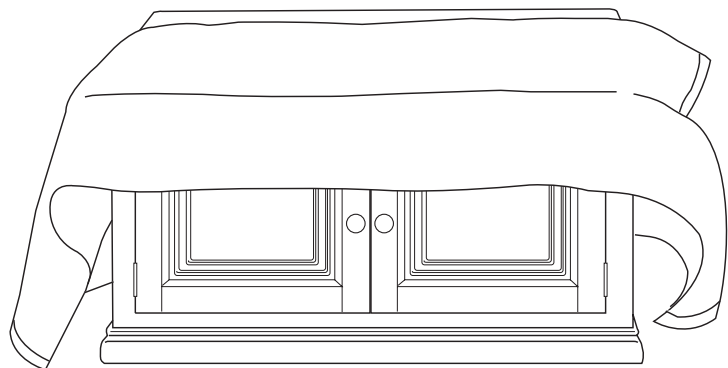

To prevent scratches, drape furniture pad on top of base section approximately 4" forward from back side in center of base section.

## Step 5

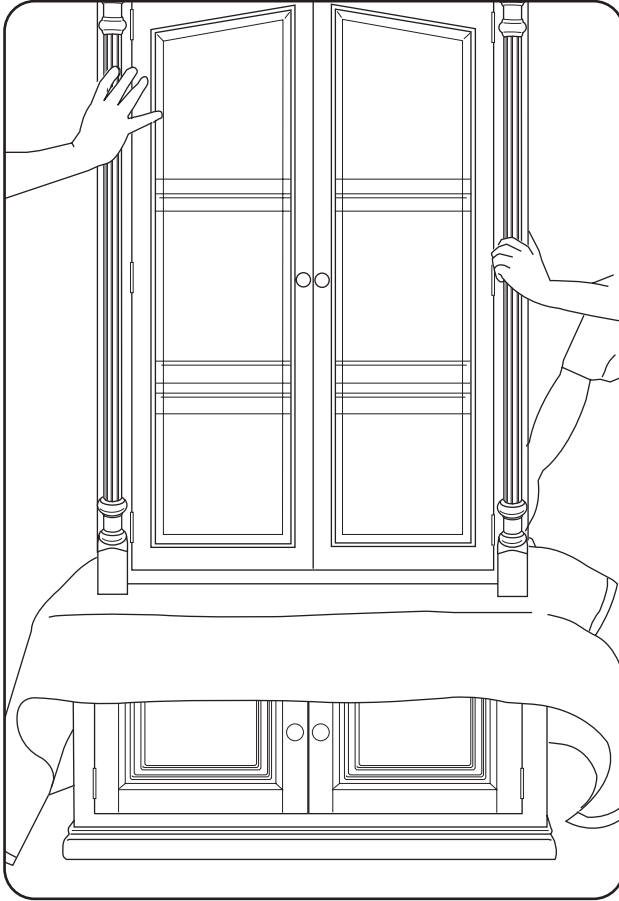

Place top section on base.  
Line up flush in back and  
center left to right.

While steadying top section,  
tilt back and remove furniture pad.

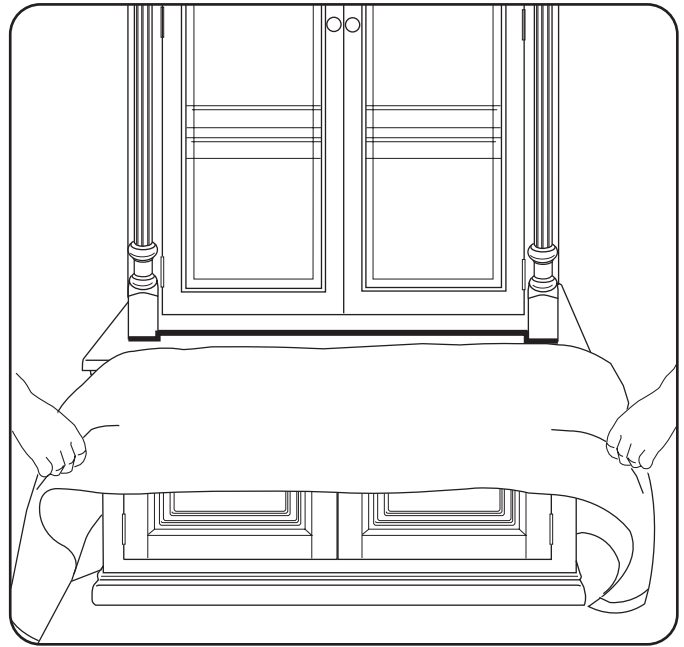

# Align and Attach the Top Section

## Step 6

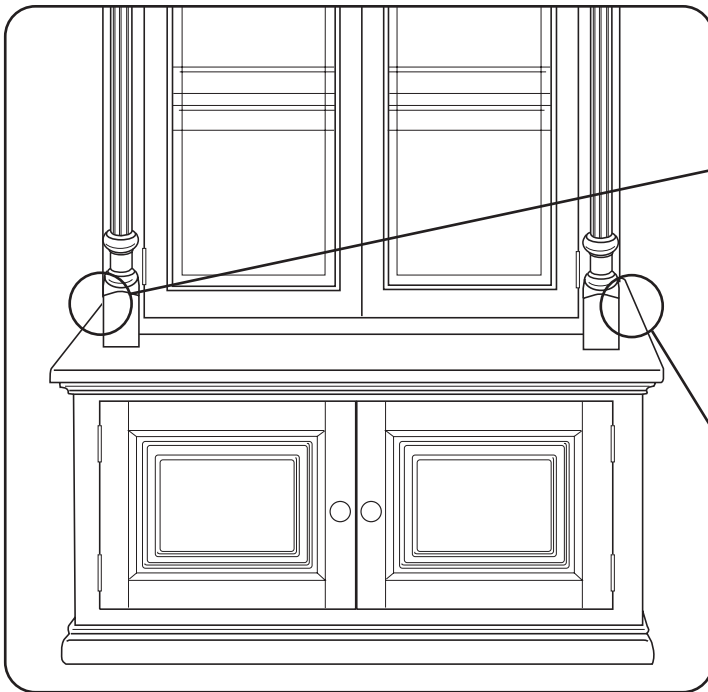

Flush the back of the top section and the base section.

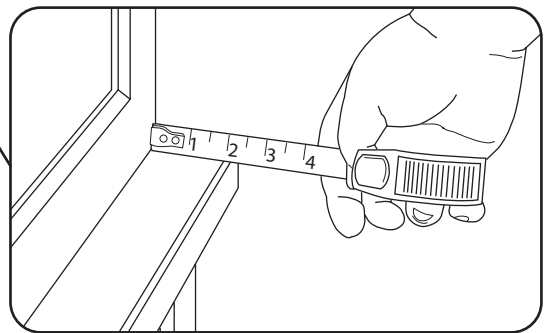
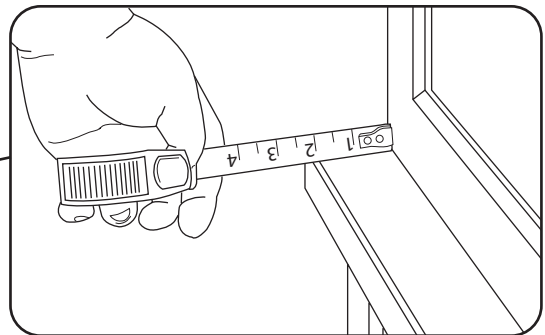

Measure left and right sides of cabinet. Center top section on base.

## Step 7

Unlock safe door. Attach top section to base.

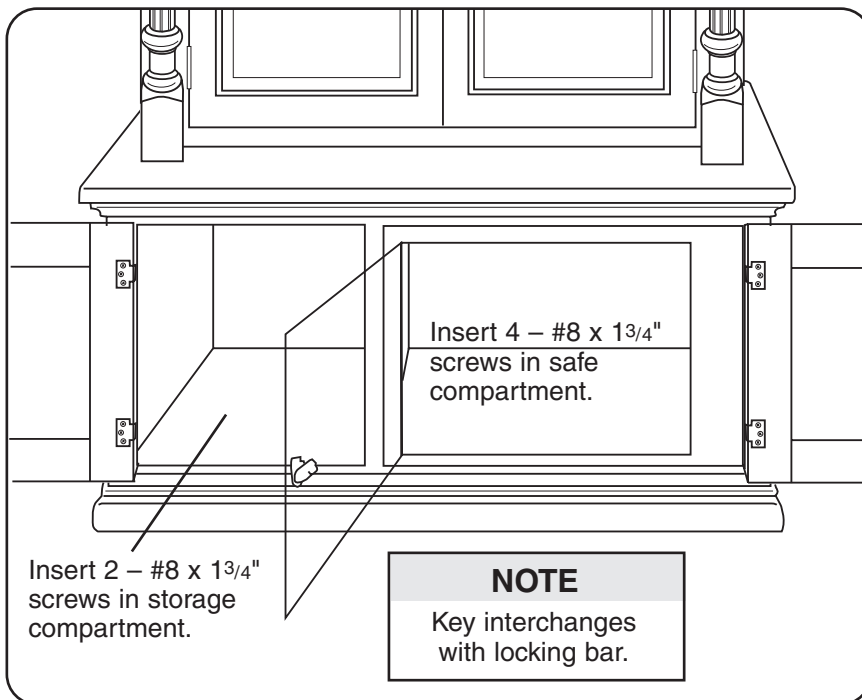

Use pre-drilled holes.

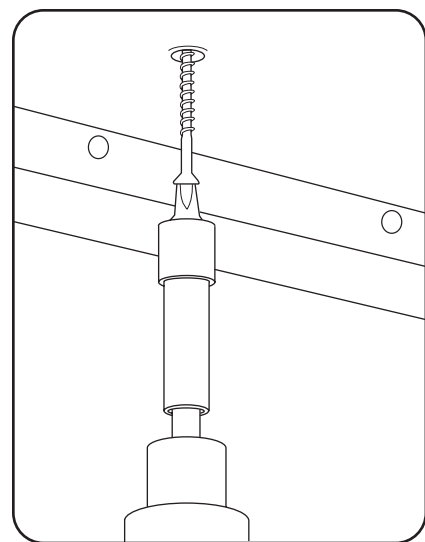

**NOTE**  
If drawers are selected, see page 8 for removal.

## Plug in the Lights

### Step 8

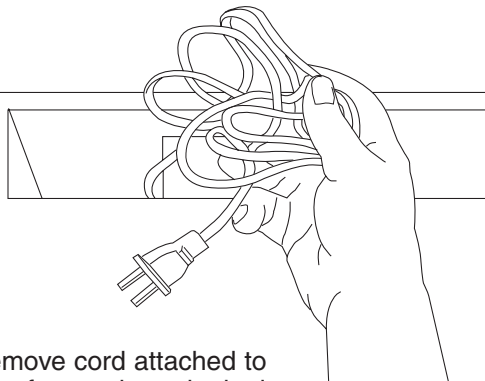
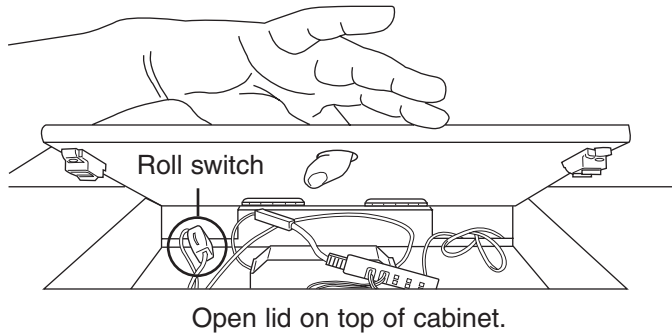

Touch center right hinge to turn light on and off.

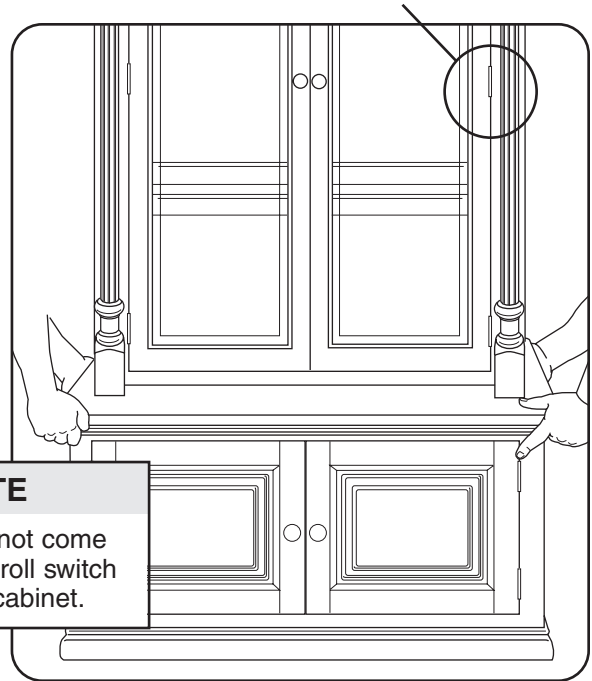

**NOTE**  
If lights do not come on, activate roll switch in top of cabinet.

Lift and slide cabinet back against the wall. Do not scratch floor. Do not smash plug in if lights are plugged in directly behind cabinet.

## Remove Locking Bar

### Step 9

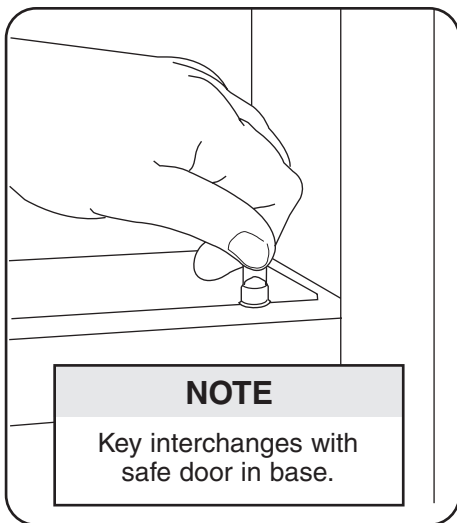

Unlock with key provided.

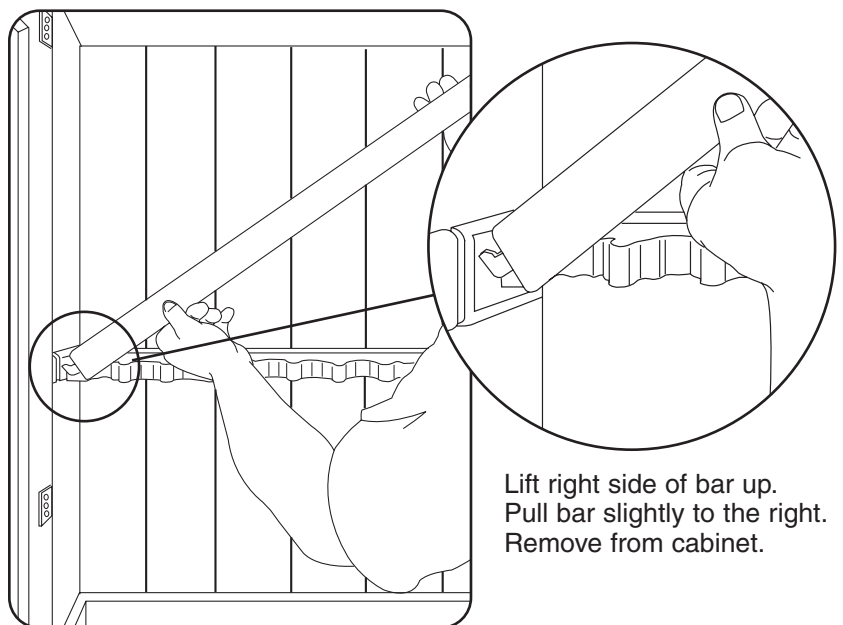

## Step 10

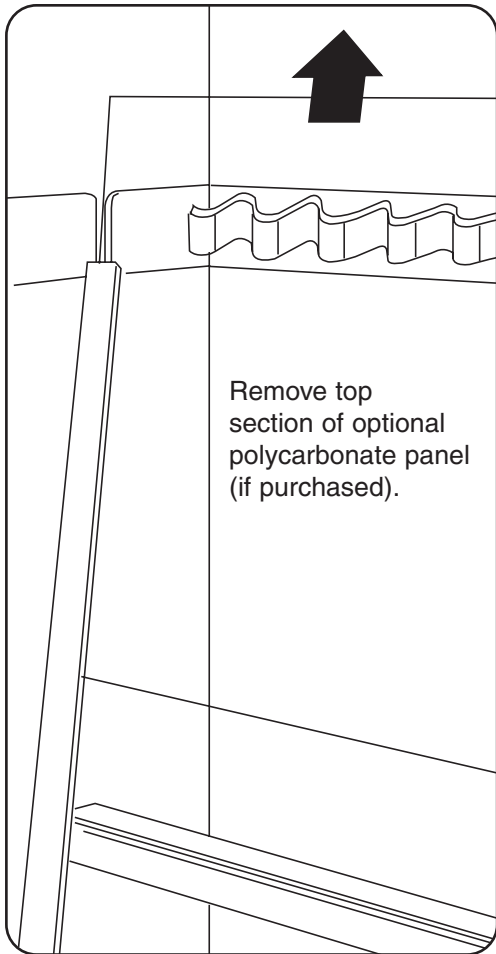

Remove top section of optional polycarbonate panel (if purchased).

You are now ready to put your guns into your GunSafe cabinet.

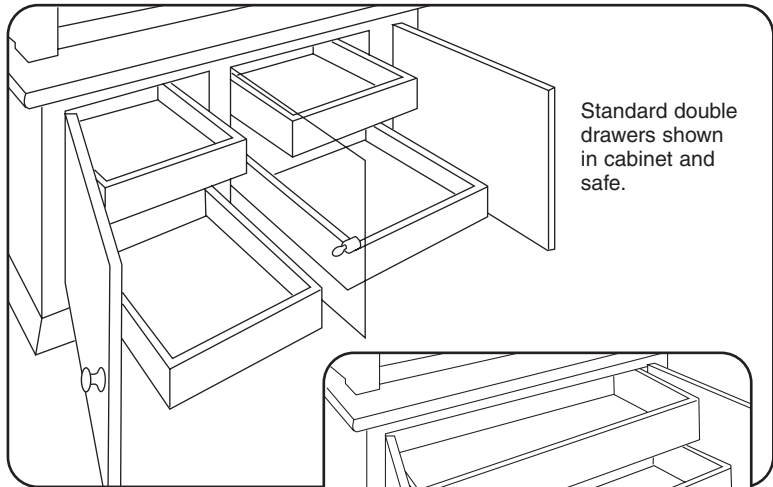

Standard double drawers shown in cabinet and safe.

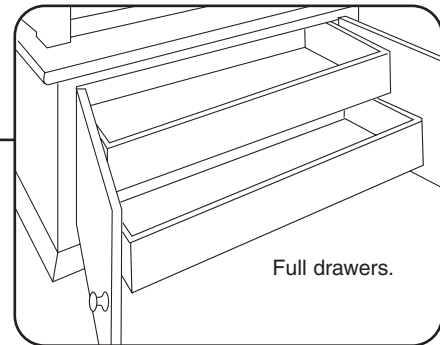

Full drawers.

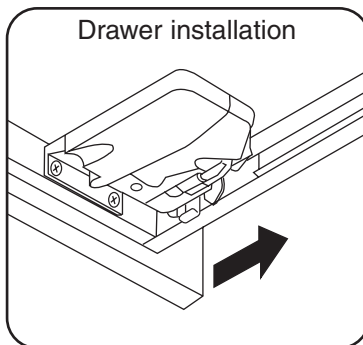

Drawer installation  
Place drawer on runners and close. Locking devices will automatically engage runners.

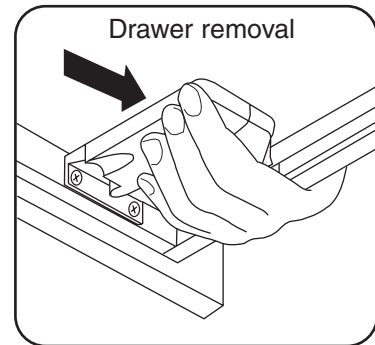

Drawer removal  
Squeeze orange handles on locking devices in front on bottom side of cabinet. Pull drawer out and up.



## Step 1

Refer to GunSafe unpacking instructions steps 1-3 (pages 3 & 4).

- Do Not cut with knife.
- Use scissors to remove shrink wrap.
- Use snips to remove banding.
- Unpack your GunSafe Deluxe cabinet.
- Remove all packing materials.
- Remove drawers from base cabinet. (Refer to step 10 instructions on page 13)

## Install Back Center Panel

### Step 2

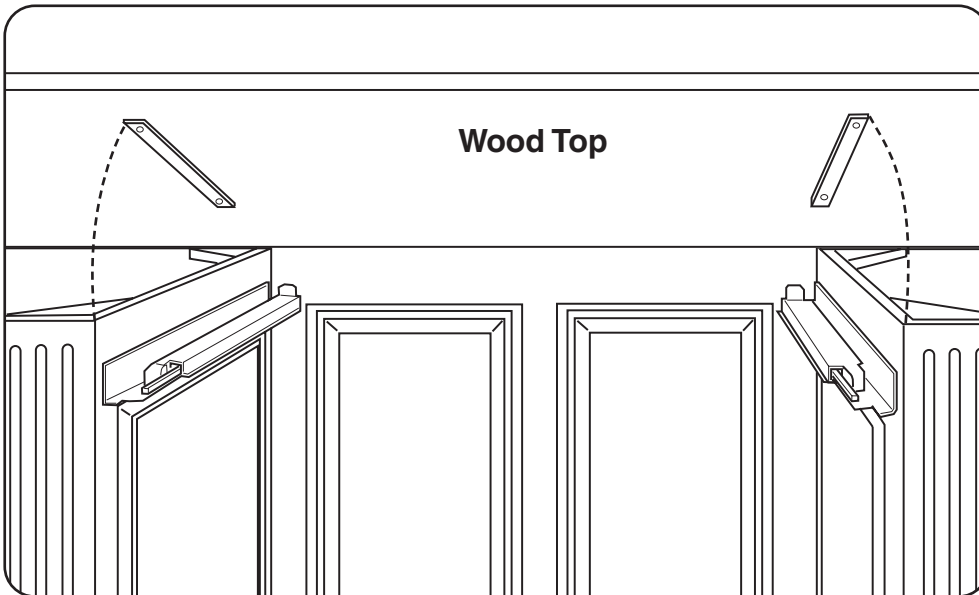
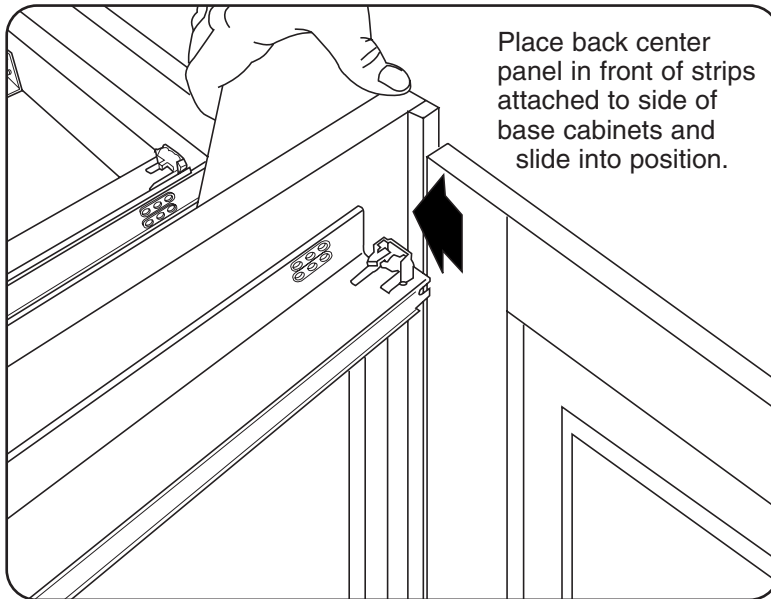

Install wood top on base cabinets. Align strips on underside of wood top with edge of base cabinet.

#### NOTE

Accurate alignment is necessary for counter drawer to work properly.

## Step 3

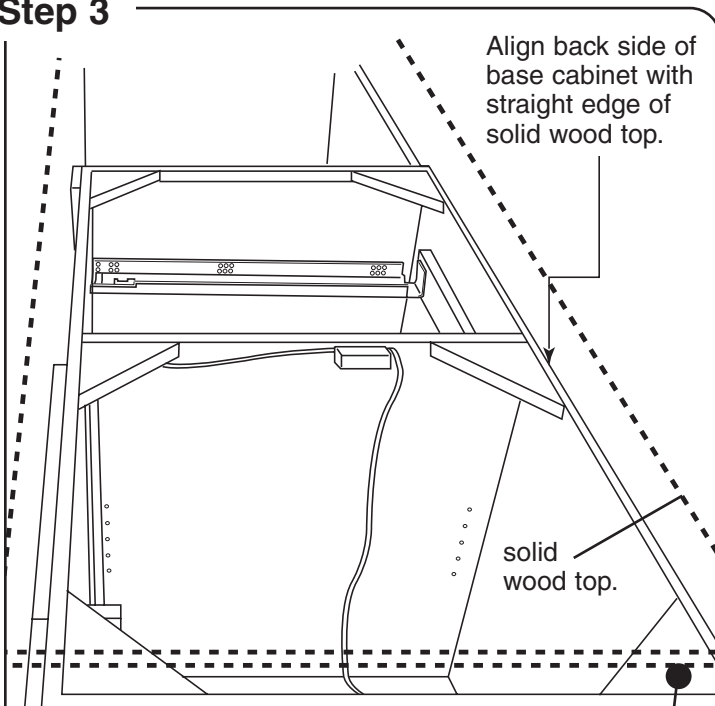

**NOTE**  
Measure both ends and make certain top is centered.

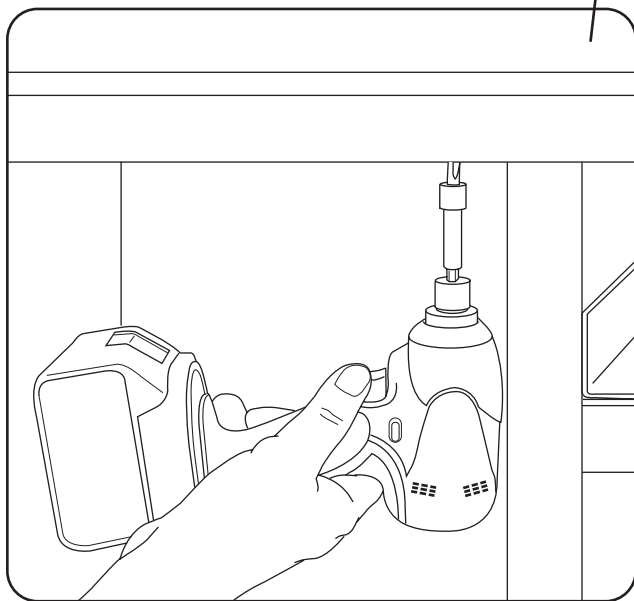

Attach wood top from the bottom in pre-drilled holes with 24 – #8 x 1 1/4" screws. 2 – per corner block.

## Step 4

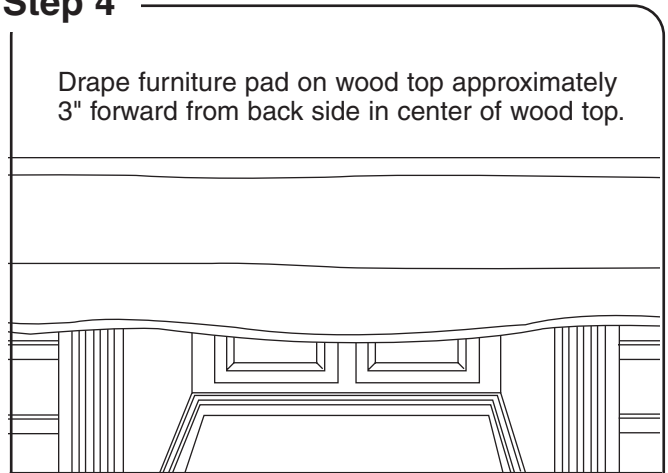

Drape furniture pad on wood top approximately 3" forward from back side in center of wood top.

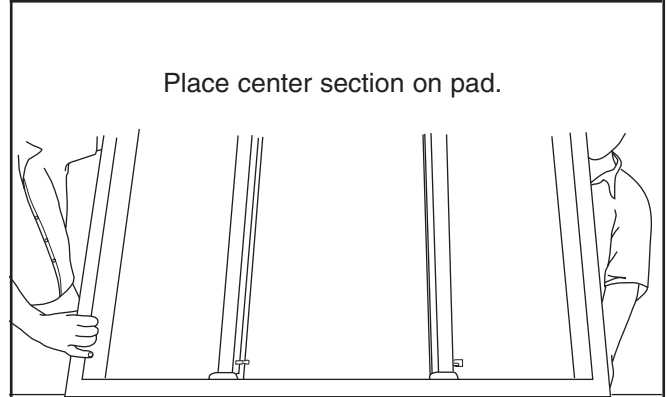

Place center section on pad.

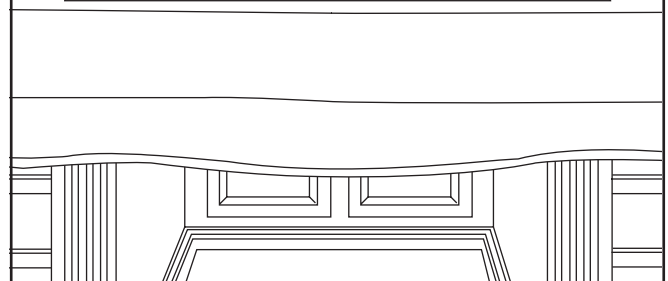

Hold cabinet steady with one hand towards top. Tilt back and remove furniture pad.



## Step 5

Measure center section left and right side. Place in center and flush in back.

Install 1 - #8 x 1 1/2" screw in each end from bottom up.

## Step 6

Place furniture pad on left side. Hold forward 3" from back.

**NOTE**  
Raised panel ends should be on outside.

Place left end cabinet on pad and align flush back and firmly against center cabinet. Steady cabinet with 2-hands. Tilt back and remove blanket. Repeat for right side.

Make certain that the end cabinets are still firmly against center cabinet and flush in back. Install 1 - #8 x 1 3/4" screw on each side in bottom pre-drilled holes.

## Step 7

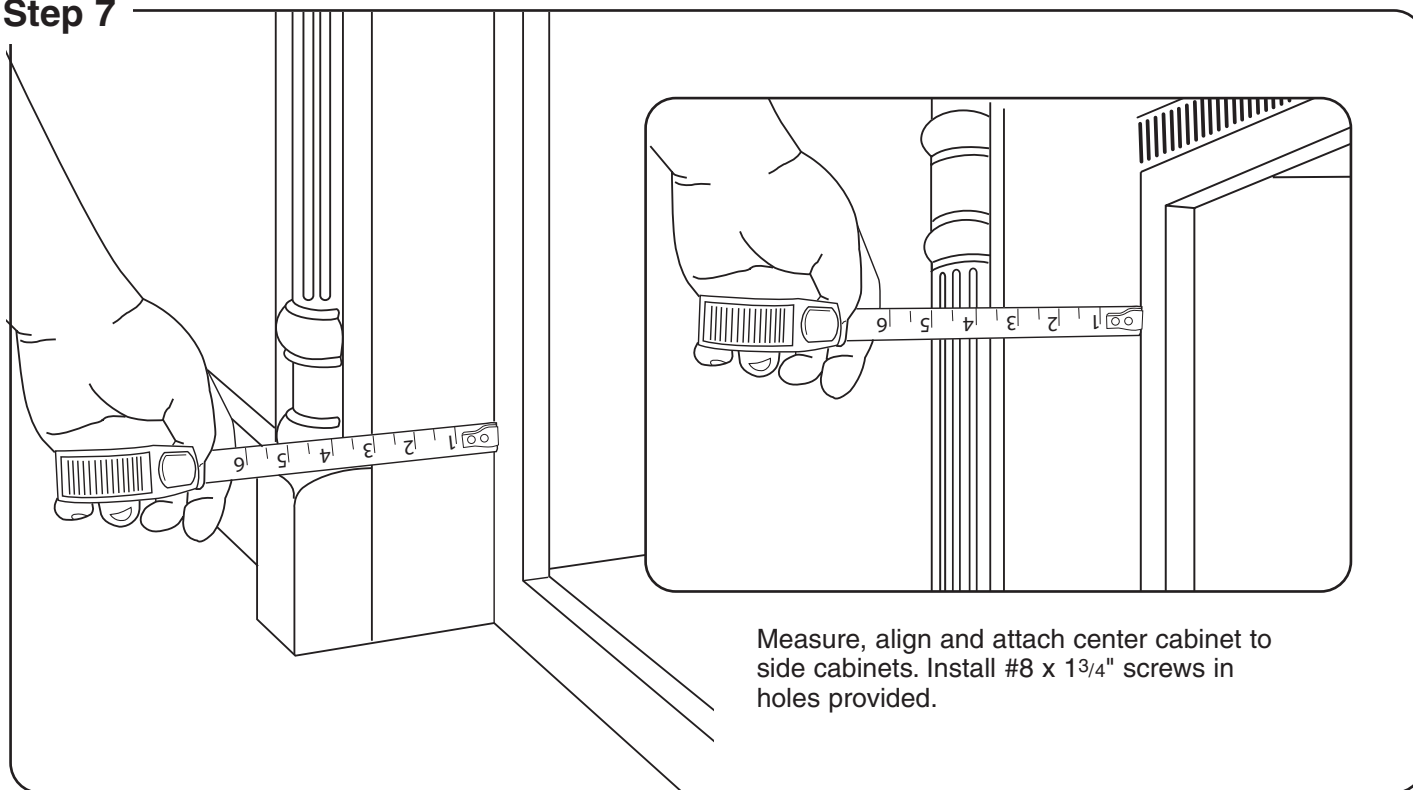

## Step 8

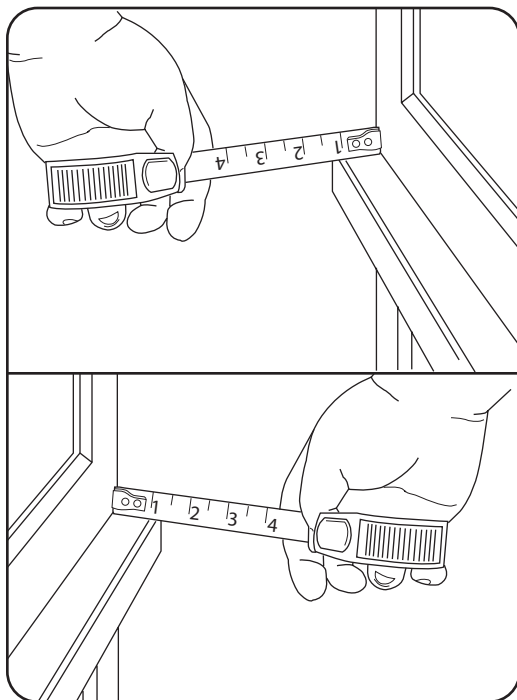

Measure both ends and make certain cabinets are centered on top. If they are not, loosen the 2-screws that attach the center cabinet to the wood top.

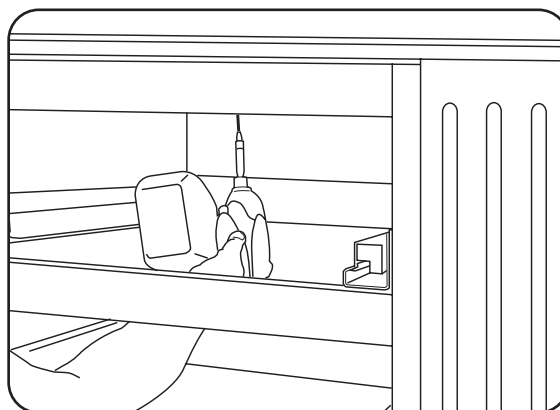
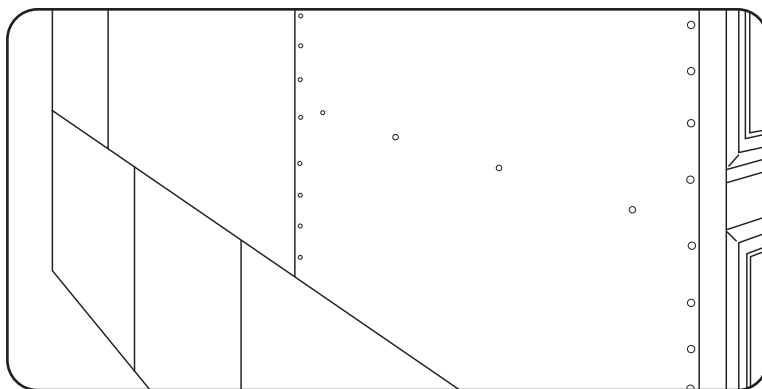

Adjust as needed and align cabinets in back. Install #8 x 1<sup>1</sup>/<sub>2</sub>" screws up thru wood top into upper cabinets in holes provided.

## Step 9

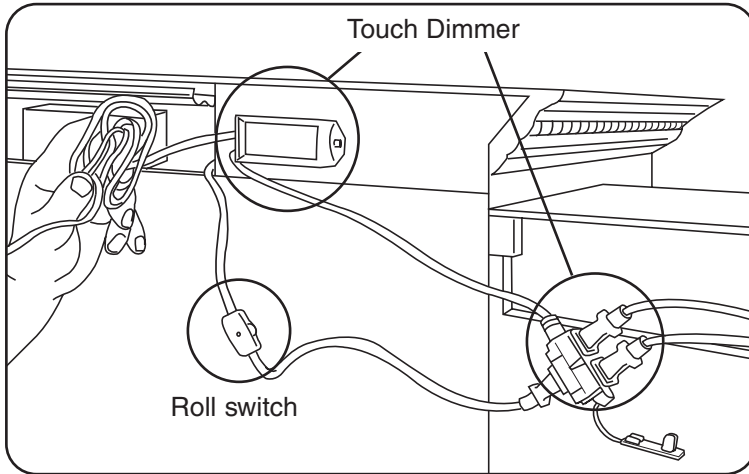

Left and center upper cabinet cords plug into Touch Dimmer mounted on back of right upper cabinet. Touch Dimmer plugs into wall outlet. Plug in lights from base cabinet. (optional feature)

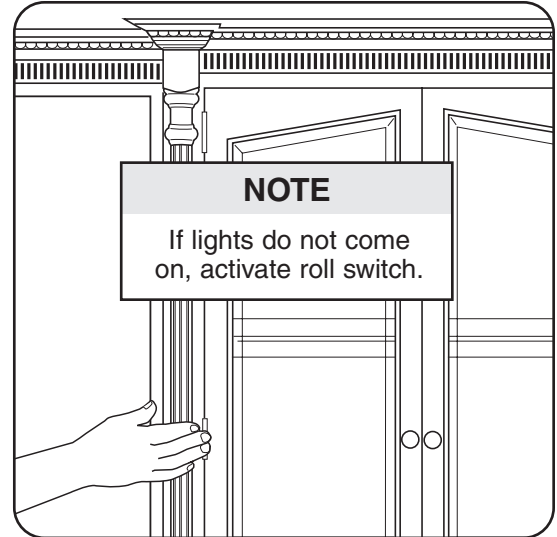

**NOTE**  
If lights do not come on, activate roll switch.

Touch left center hinge on upper right cabinet to activate lights.

**You are now ready to move cabinet back against wall.** Lift up slightly and put a furniture pad or rug under each corner of base cabinets. Do not slide before padded as this may scratch the floor.

## Drawer Removal and Installation

### Step 10

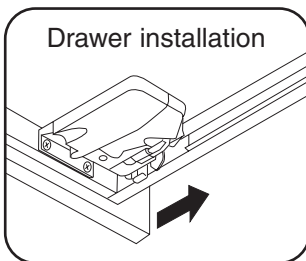

Drawer installation

Place drawer on runners and close. Locking devices will automatically engage runners.

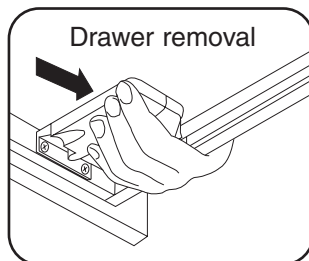

Drawer removal

Squeeze orange handles on locking devices in front on bottom side of cabinet. Pull drawer out and up.

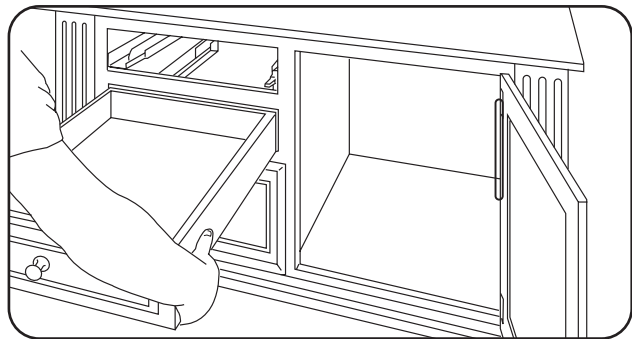

### Step 11

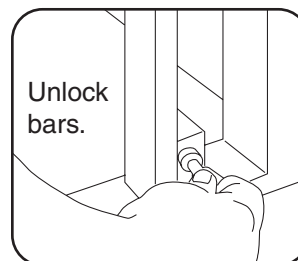

Unlock bars.

Grasp bar firmly with 2 hands and swing bottom to right. Bar will release at top. Repeat for 2nd bar. **You are now ready to put guns in your cabinet.** Reverse procedure to install bars.

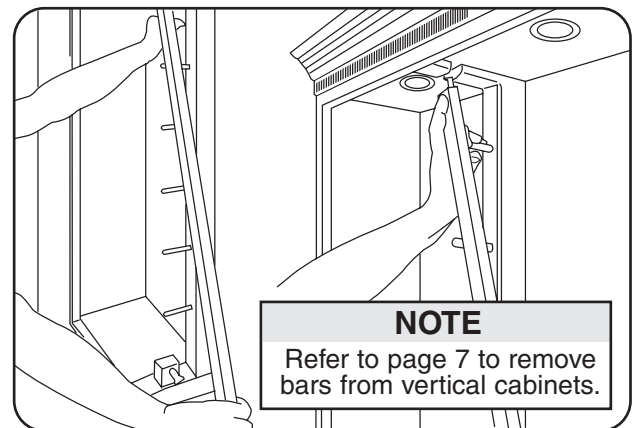

**NOTE**  
Refer to page 7 to remove bars from vertical cabinets.

## Tools Needed

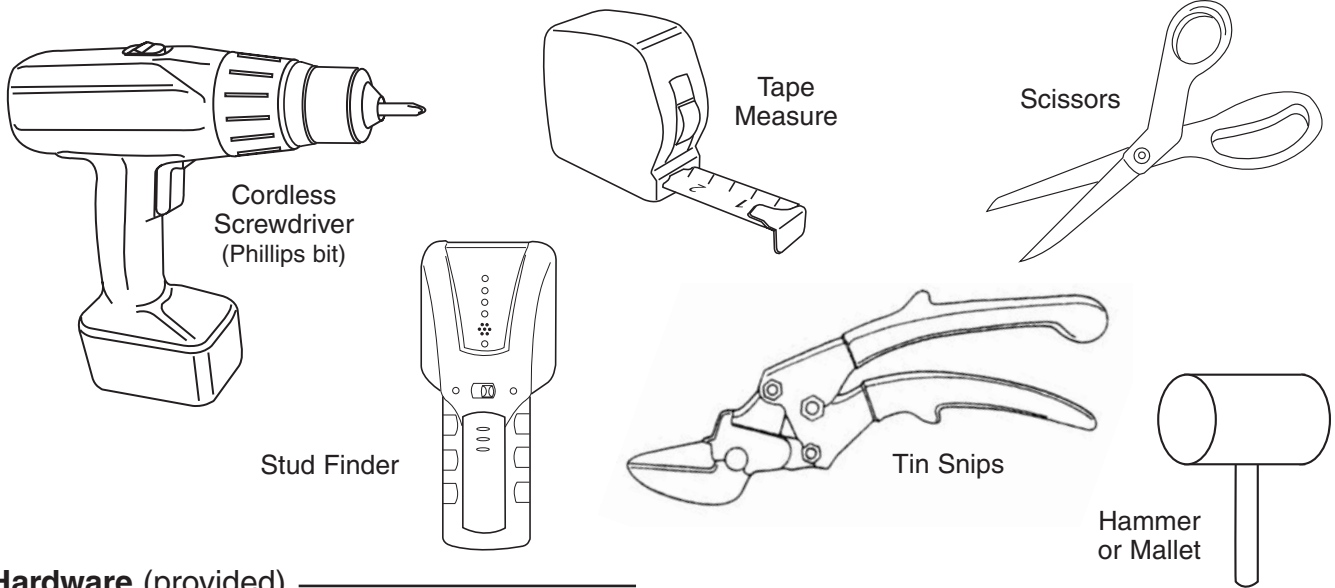

## Hardware (provided)

Screws for GunSafe Pistol Display



#12 x 3 1/2"



Buttons to cover screw holes

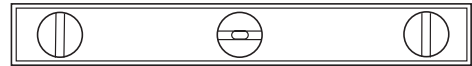

Level

## Step 1

Carefully unpack your GunSafe Pistol Display.  
Remove all packing materials.

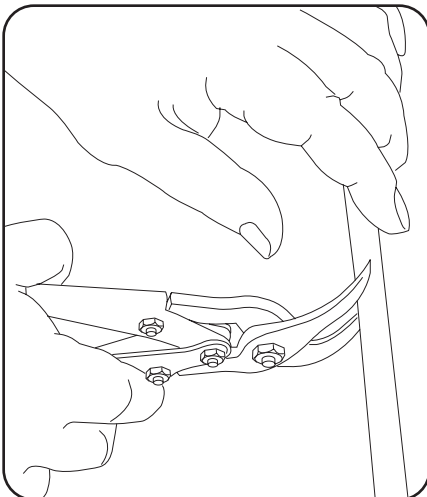

Use a tin snips to cut plastic bands.

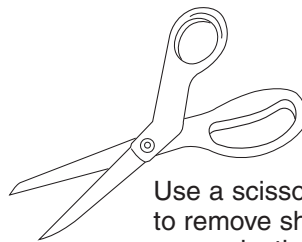

Use a scissors to remove shrink wrap, plastic and tape.

Do Not use knife.



### NOTE

It is necessary for 2 or more people to set up your GunSafe Pistol Display.

## Step 2

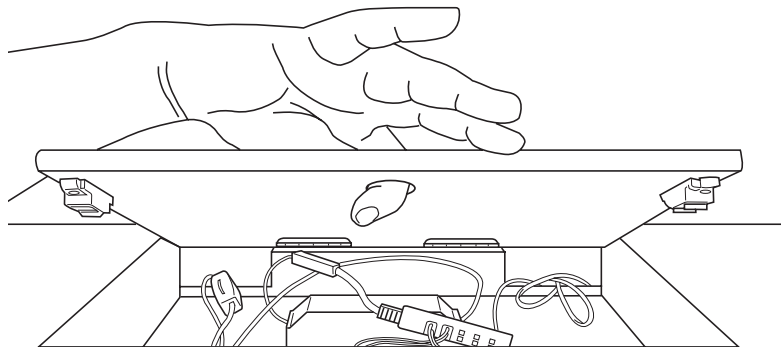

Open lid on top of Pistol Display.

### NOTE

Keys and hardware are inside light components access door on top of Pistol Display.

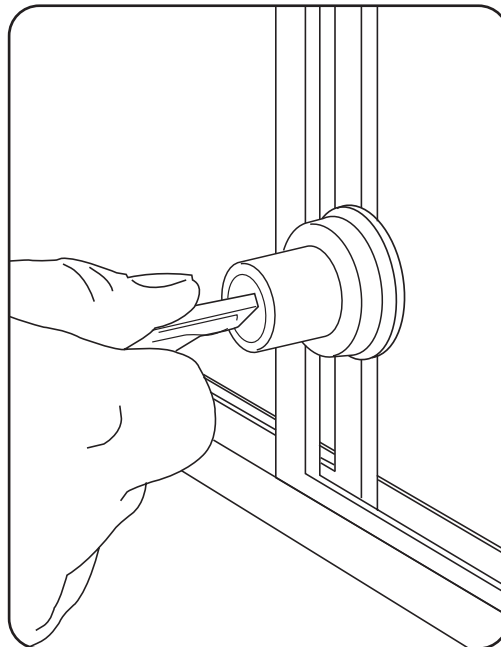

Unlock Pistol Display Door.

## Step 3

### NOTE

Mounting holes are drilled for 16" on center studs.  
If studs aren't 16" on center, drill 1/2" hole for button 1/4" deep and 3/16" hole through mounting rail.

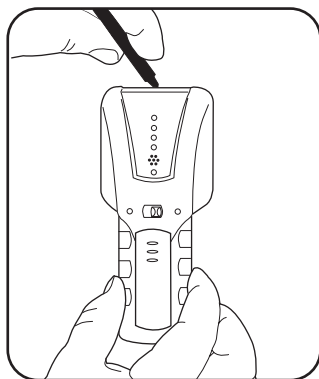

Using a stud finder, locate the wall studs.

**For maximum security, Pistol Display needs to be anchored to wall through studs!**

### NOTE

Place Pistol Display near electrical outlet for light kit.

Drywall

Stud

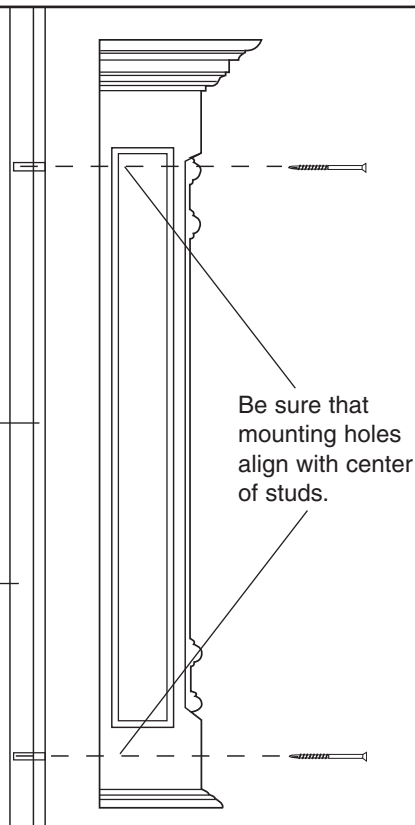

## Step 4

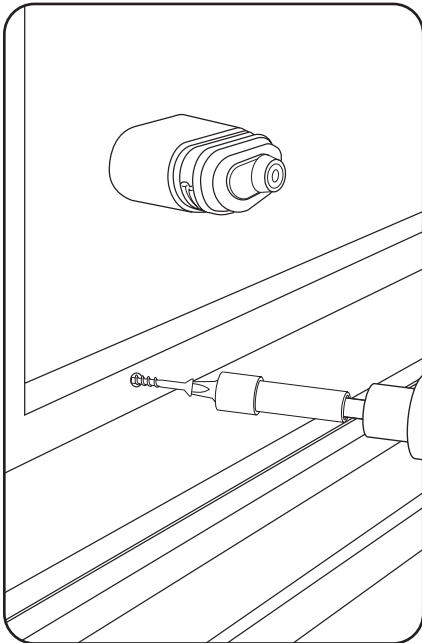

Drive 3 1/2" screws through holes provided. Make certain screws are anchoring in wall studs.

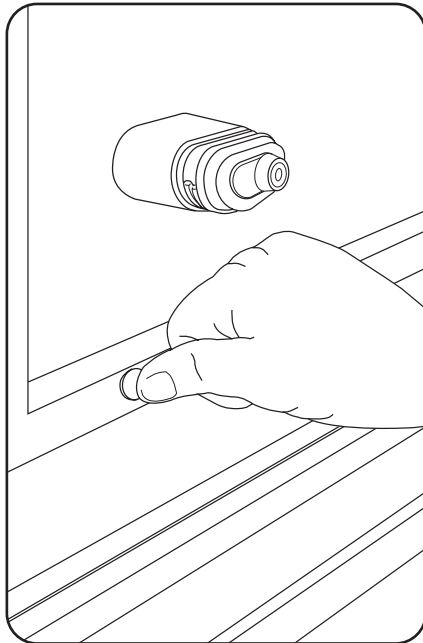

Insert screw covers

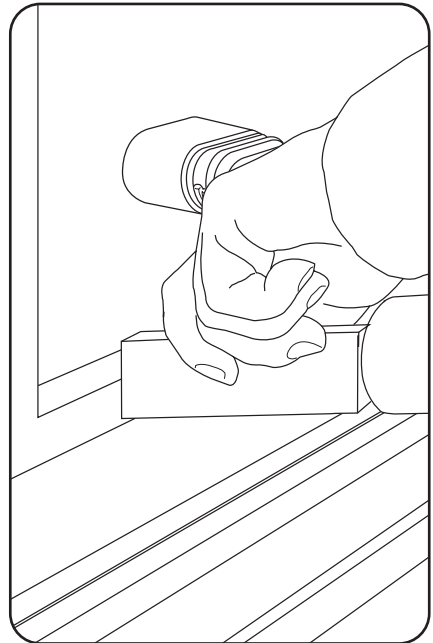

Using a short board and hammer, lightly tap button until seated.

## Step 5

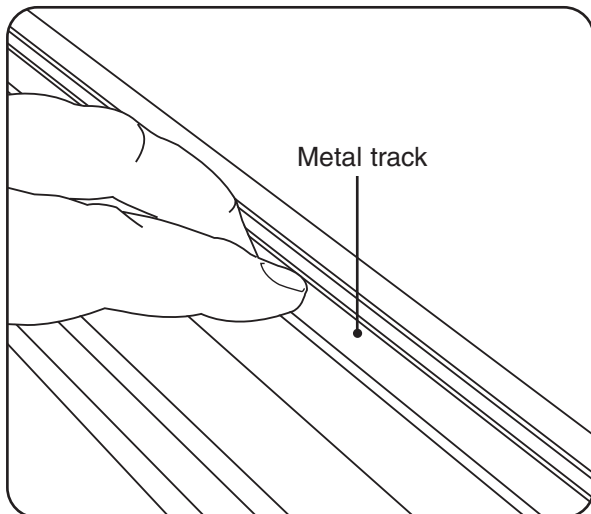

### Plug in the lights!

Light switch is touch activated. Touch the metal track to turn lights on and off.



## Step 6

You are now ready to load your display with pistols!

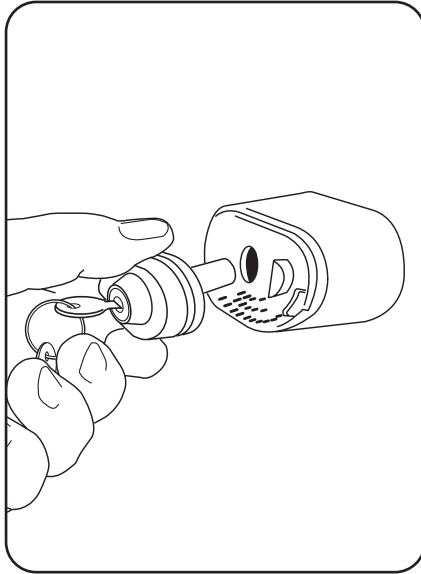

Using small keys, remove all trigger locks. Turn back into locked position before removing key.

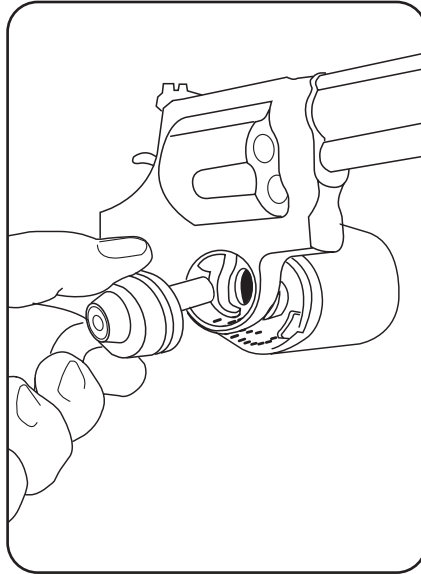

Insert trigger lock through pistol trigger guard.

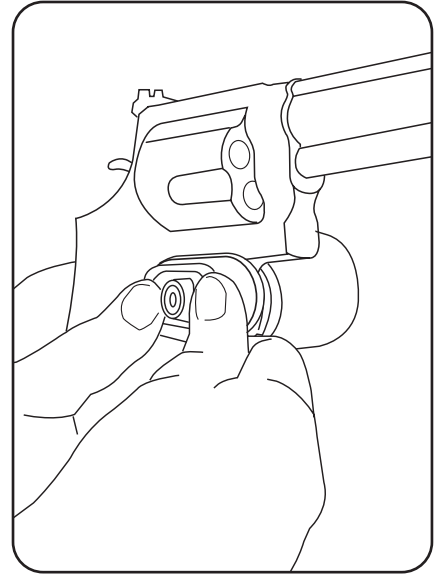

Press firmly into position.

## Step 7

If the trigger guard doesn't properly hold pistol in position, install optional magnet to support barrel of pistol. (option #GS94055)

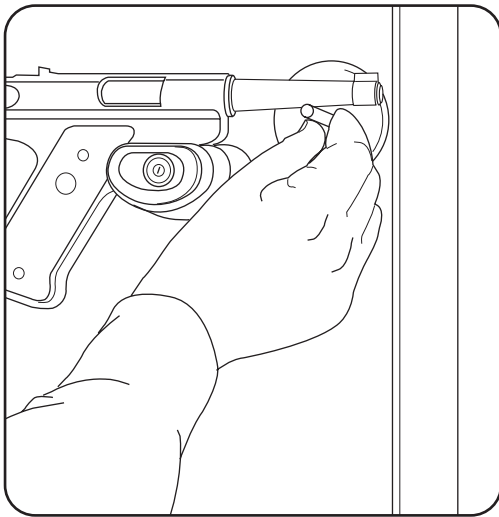

### NOTE

Magnets are usually only needed on larger pistols.

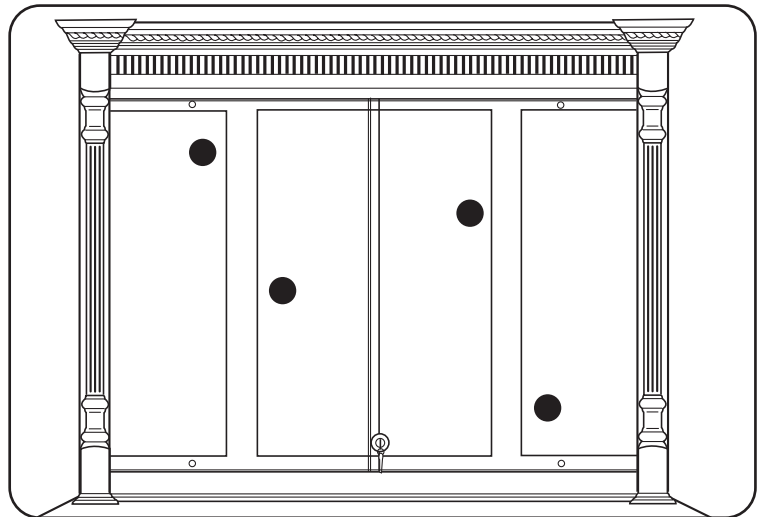

The magnets can be applied at any height to left and right of upright supports.

## Step 8

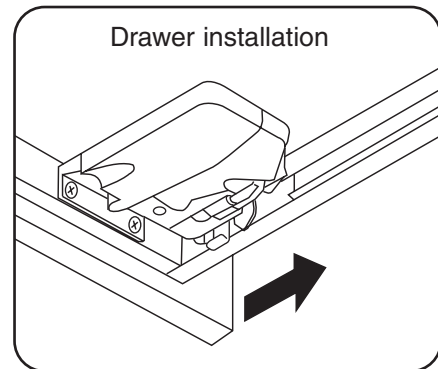
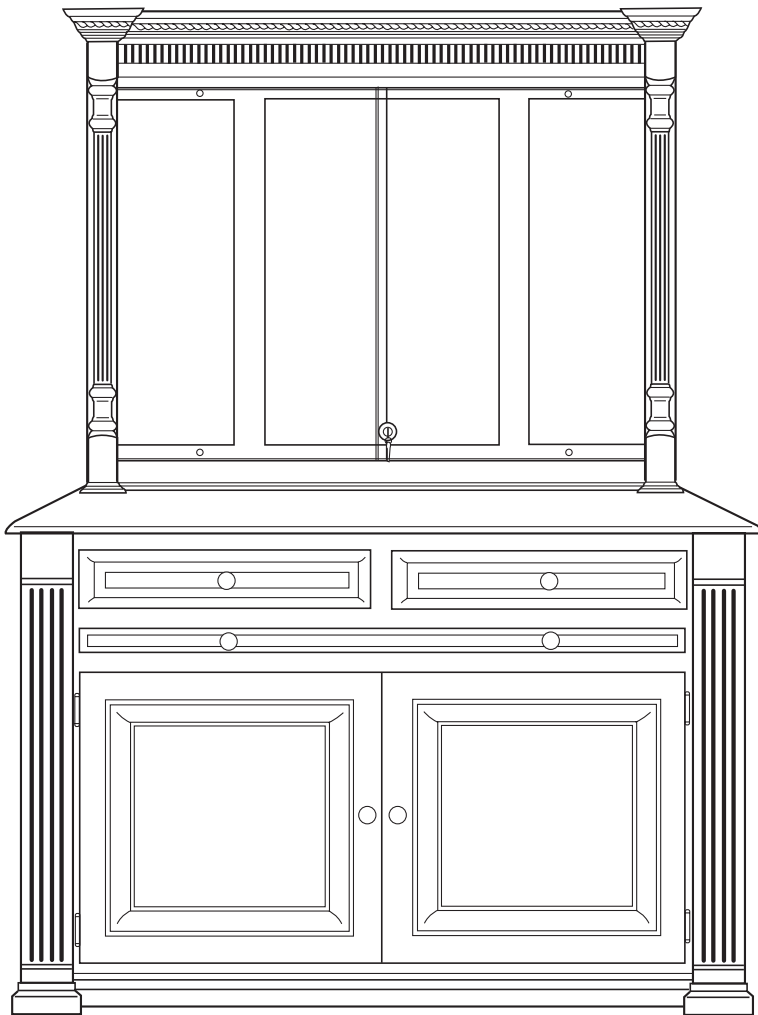

Place drawer on runners and close. Locking devices will automatically engage runners.

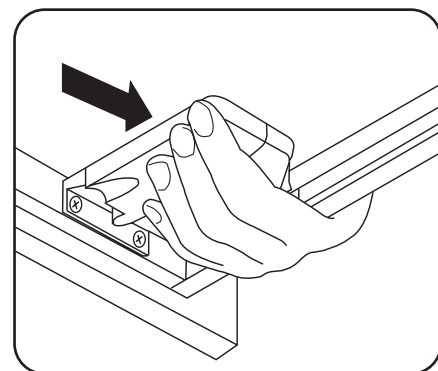

Squeeze orange handles on locking devices in front on bottom side of cabinet. Pull drawer out and up.

### NOTE

Be careful not to damage top of base.

**Go to Step 3** and determine location of pistol display. Set base at desired position against wall. Near an electrical outlet.

Place Pistol Display on top of base and anchor to wall as per instructions in **steps 3 & 4**. It is not required to attach Pistol Display to base.

Place shelves at desired height. Shelves are fully adjustable.

From the Desk of William Schlabach, GunSafe founder...

We are a small family owned business nestled in a rural community in central Illinois.

We are pleased to offer a steadily growing product line to our customers. Our most recent offering is very unique. A beautiful and secure Pistol Display. It is now available with an optional base that features a gun cleaning shelf and matching desk chair.

In addition to hand-crafted GunSafe cabinets, we offer other custom furniture, including dining room hutches, custom library units, kitchen cabinets, entertainment centers, office desk units and more.

Feel free to call anytime to discuss your special needs and projects. We would be pleased to answer questions and provide quotations for specialized requests. Our phone number is 1-877-448-6723.

We ship our product nationwide and abroad.

Sincerely,  
William Schlabach

***Protecting An Investment  
Showcasing Your Collection***

**GunSafe™**

Customer Name: \_\_\_\_\_

Model #: \_\_\_\_\_

Serial #: \_\_\_\_\_

Craftsman: \_\_\_\_\_

Inspected by: \_\_\_\_\_

Date: \_\_\_\_\_

**NOTE**

Keep this manual in a safe place  
for future reference.

Designed and  
Manufactured by:

**GunSafe™**

160 E CR 240 N  
Arthur, IL 61911  
Tel: 877-4GUNSAFE (48-6723)  
Fax: 877-5GUNSAFE (48-6723)

*Satisfaction Guaranteed*